



OLIVER BURN



Flat C
143a Coldharbour Lane
SE5 9NU
£310,000
Leasehold



**Stunning Newly Refurbished
One Bedroom Flat**

- ◆ One Bedroom
- ◆ Stylish Kitchen With Corian Work Surface
- ◆ Recently Renovated To High Standard
- ◆ Solid Walnut Flooring
- ◆ Video Entry Phone System
- ◆ Chain Free



*EARLY VIEWING IS RECOMMENDED, BUT STRICTLY BY
APPOINTMENT WITH OLIVER BURN ;
0207 274 3333 www.OliverBurn.com
5 Half Moon Lane, Herne Hill, SE24 9JU*





OLIVER BURN

Property Details

A beautifully presented one bedroom, first floor flat for sale, situated in this desirable location, close to the superb amenities of both Brixton and Camberwell

This lovely flat has been meticulously refurbished and benefits from a high spec finish, fully eco friendly compliant regulations including up to the minute soundproofing and finished with the finest Corian work surfaces and solid walnut and flooring throughout.

It is conveniently situated within close proximity to Kings College hospital and well connected train stations such as Loughborough Junction, Denmark Hill and Brixton tube & mainland Station, all accessing West End and City.

This property is offered to the market with the benefit of no onward chain.



TOTAL APPROX. FLOOR AREA 260 SQ.FT. (24.2 SQ.M.)

For illustrative purposes only. Decorative finishes, fixtures, fittings and furnishings do not represent the current state of the property. Measurements are approximate. Not to scale
Made with Metropix ©2014

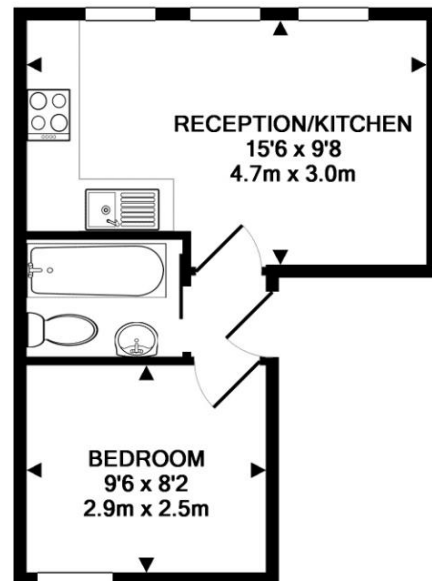
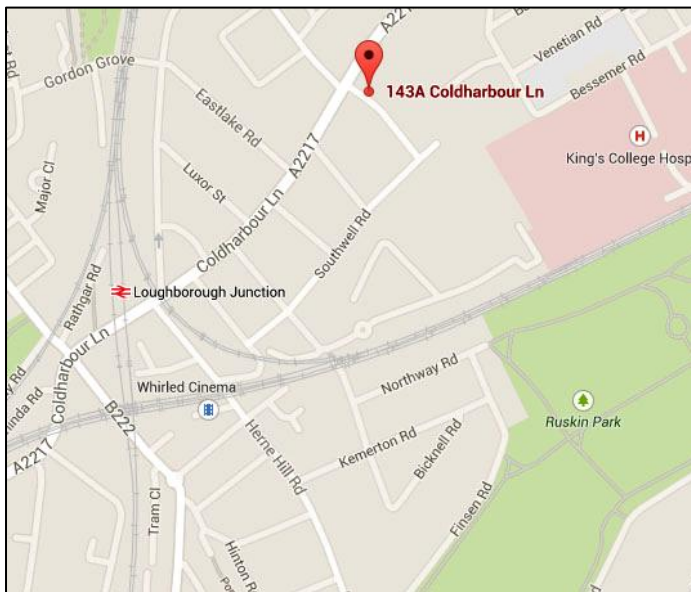

Every attempt is made to ensure accuracy, however measurements are approximate, for illustrative purposes and may not be to scale. These particulars shall not be construed as an offer, contract or any part thereof. Statements in these particulars are not binding and are made without warranties on the part of Oliver Burn Residential Ltd, its employees or its clients. Intending purchasers must verify all statements by inspection or otherwise.

0207 274 3333

www.OliverBurn.com

5 Half Moon Lane, Herne Hill, SE24 9JU